



Timber Ridge HOMES

the Mystic Point

*Design-Built quality custom homes in Urban,
Rural and Recreational settings in B.C. and Alberta*



Width: 60 ft | Depth: 35 ft | Main Floor: 1280 sq.ft. | Upper Floor: - | Total Area: 1280 sq.ft.

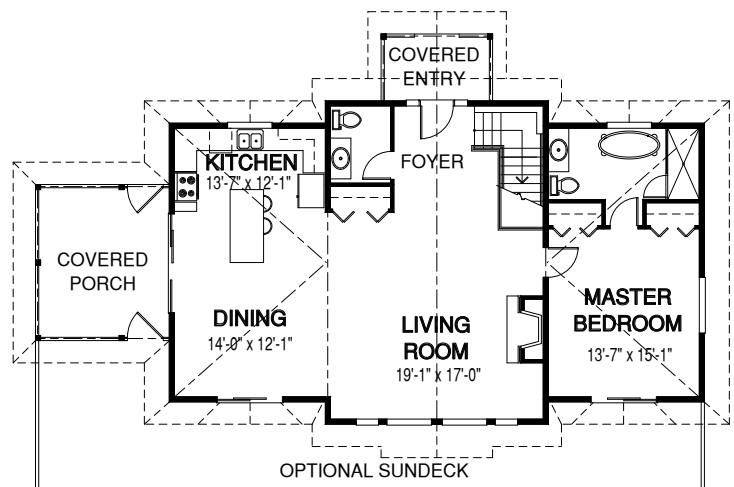
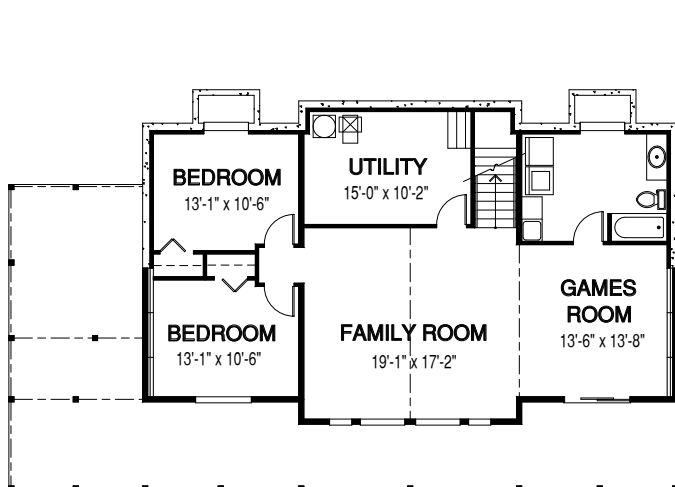

Contact us today for more details and pricing: www.timberidge-homes.com 1 - (888) 291-7040
 An optional **basement/walkout, Garage** (attached, detached or semi-detached) can be added to every design